

1640 W FULTON ST

CHICAGO, ILLINOIS



Virtual Tour



W FULTON ST

**12,791 SF // RARE ±4:1,000 SF CAR PARKING RATIO
AVAILABLE FOR LEASE IN CHICAGO'S KINZIE CORRIDOR**

Matt Cowie

First Vice President
+1 312 334 7203
matt.cowie@cbre.com

John Marks

Senior Associate
+1 312 334 7204
john.marks@cbre.com

Larry Goldwasser, SIOR

Executive Vice President
+1 312 334 7201
larry.goldwasser@cbre.com

OWNED BY:



DRH

CBRE

HIGHLIGHTS



Total Building Size:	12,791 SF
Total Site Size:	±0.61 acres (25,668 SF)
Available SF:	12,791 SF
Clear Height:	12'0" - 15'0"
Loading:	1 drive in door
Car Parking:	±40 spaces
Zoning:	PMD 4A
2022 Taxes:	\$3.98/PSF (estimate)
Asking Lease Rate:	Subject to offer

HIGHLIGHTS

New windows	New exterior lighting
New LED lighting	New parapet wall
Sandblasted ceilings & walls	Roof maintenance
New convenience outlets	New ADA restrooms
New concrete topping slab	Electric clean-up

1640 W FULTON STREET, CHICAGO

Matt Cowie

First Vice President
+1 312 334 7203
matt.cowie@cbre.com

John Marks

Senior Associate
+1 312 334 7204
john.marks@cbre.com

Larry Goldwasser, SIOR

Executive Vice President
+1 312 334 7201
larry.goldwasser@cbre.com

CBRE

FLOOR PLAN



Newly Renovated Space Ideal for Industrial, Office & Flex Uses

W FULTON ST

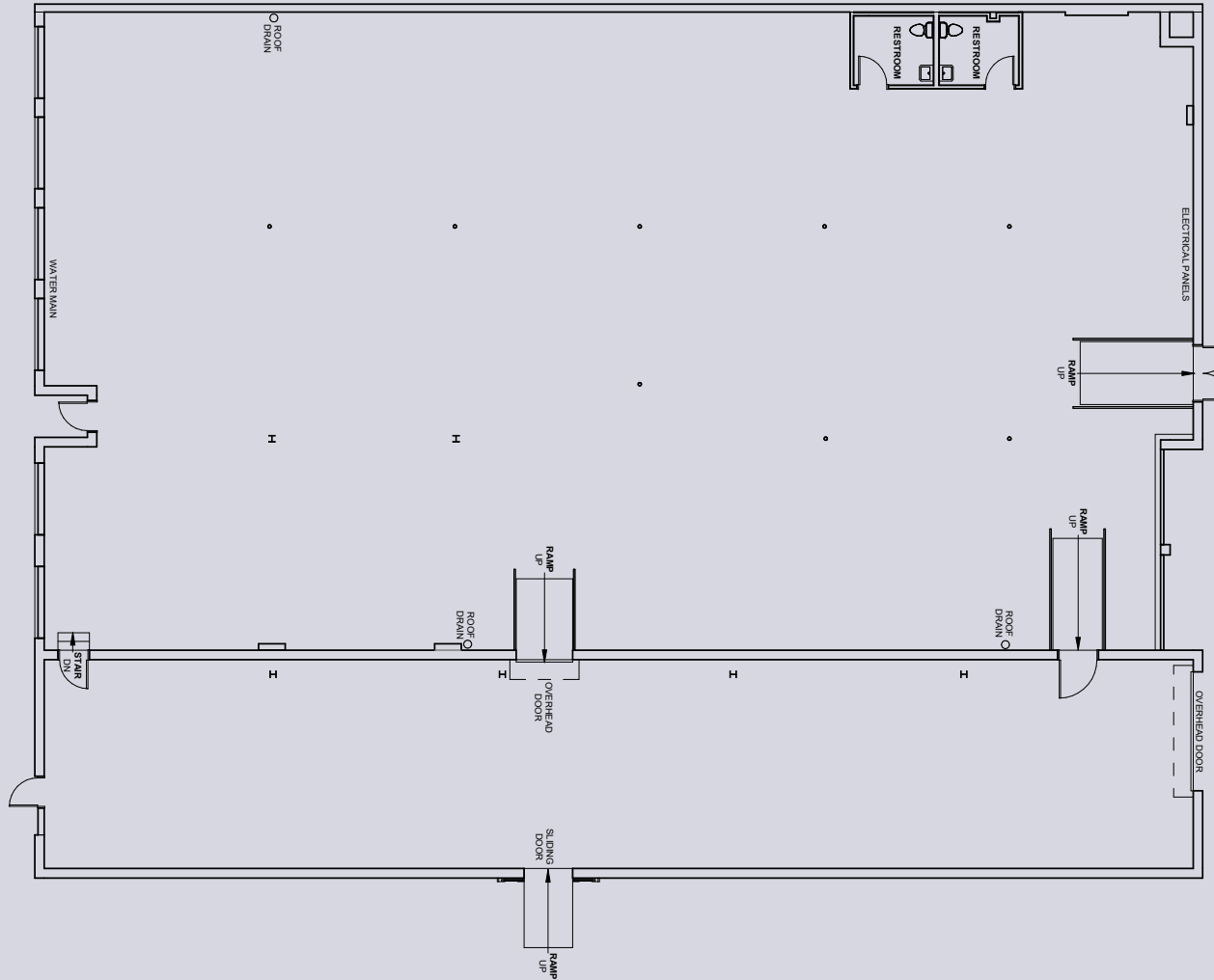

Matt Cowie
First Vice President
+1 312 334 7203
matt.cowie@cbre.com

John Marks
Senior Associate
+1 312 334 7204
john.marks@cbre.com

Larry Goldwasser, SIOR
Executive Vice President
+1 312 334 7201
larry.goldwasser@cbre.com

1640 W FULTON STREET, CHICAGO

CBRE

ACCESS MAP



Offering Exceptional Access to Public Transportation, Expressways & Downtown Chicago

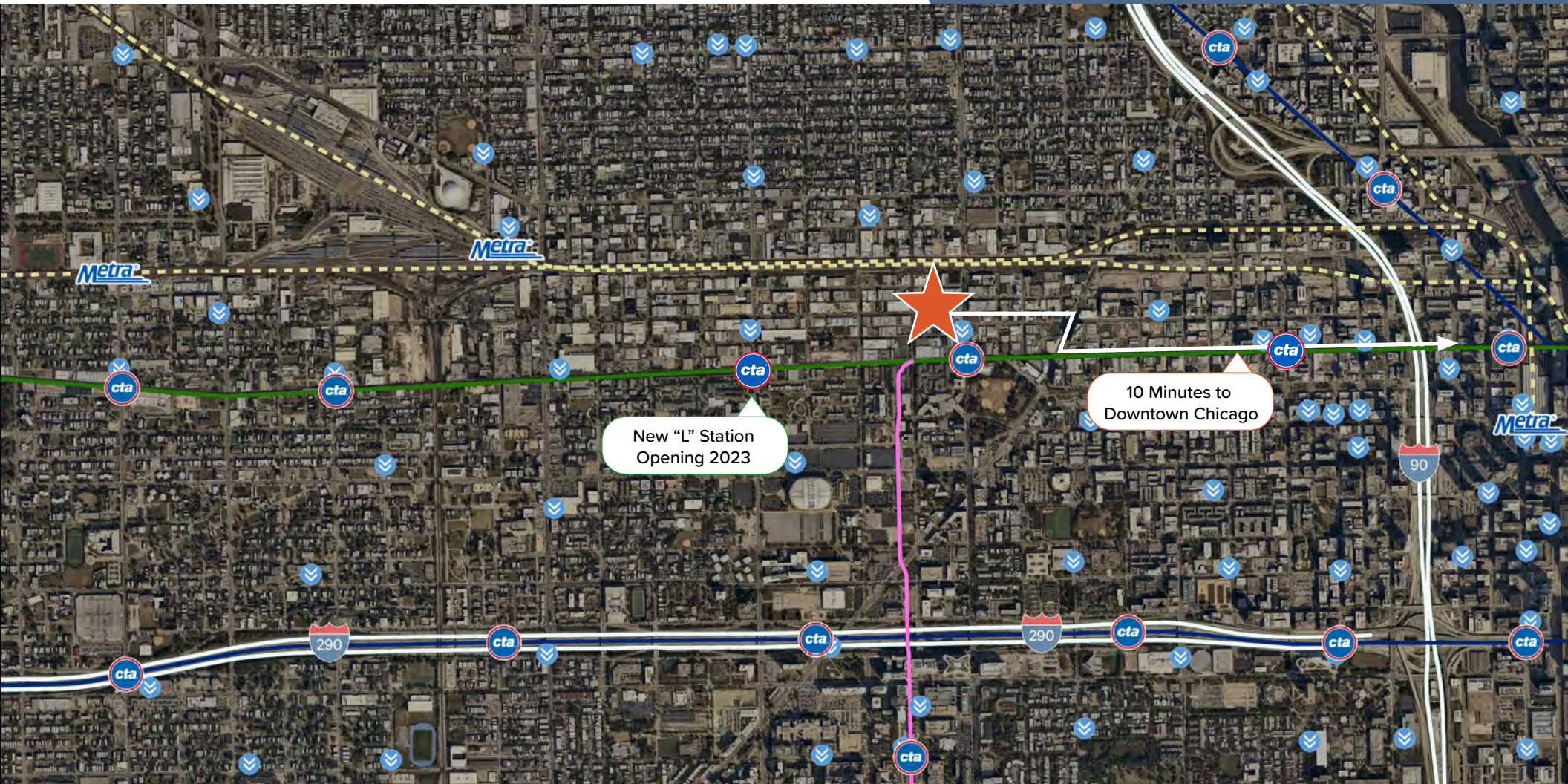

Matt Cowie
First Vice President
+1 312 334 7203
matt.cowie@cbre.com

John Marks
Senior Associate
+1 312 334 7204
john.marks@cbre.com

Larry Goldwasser, SIOR
Executive Vice President
+1 312 334 7201
larry.goldwasser@cbre.com

1640 W FULTON STREET, CHICAGO

CBRE

PROPERTY PHOTOS



Matt Cowie
First Vice President
+1 312 334 7203
matt.cowie@cbre.com

John Marks
Senior Associate
+1 312 334 7204
john.marks@cbre.com

Larry Goldwasser, SIOR
Executive Vice President
+1 312 334 7201
larry.goldwasser@cbre.com

1640 W FULTON STREET, CHICAGO

CBRE

LOCAL AMENITIES

- 1 Starbucks
- 2 Target
- 3 McDonald's
- 4 Starbucks
- 5 Walgreen's
- 6 Jet's Pizza
- 7 Ranalli's
- 8 Palace Grill
- 9 The Billy Goat Tavern
- 10 McDonald's
- 11 Dunkin' Donuts
- 12 Shake Shack
- 13 sweetgreen
- 14 Roti
- 15 Capriotti's Sandwich Shop
- 16 Wow Bao
- 17 The Loyalist
- 18 City Winery
- 19 The Corned Beef Factory Sandwich Shop
- 20 Federales
- 21 Bar Siena
- 22 Little Goat Diner
- 23 Au Cheval
- 24 La Josie
- 25 Limitless Coffee & Tea
- 26 Duck Duck Goat
- 27 Bar Takito
- 28 The Aviary
- 29 Swift & Sons
- 30 Kuma's Corner West Loop
- 31 Aba
- 32 The Aberdeen Tap
- 33 Goose Island Taproom
- 34 District Brew Yards
- 35 On Tour Brewing
- 36 CVS
- 37 D'Agostino's Pizza River West
- 38 Big Shoulders Coffee
- 39 Rose Mary
- 40 Time Out Market
- 41 Lyra
- 42 Cira
- 43 JP Graziano
- 44 Breakfast House

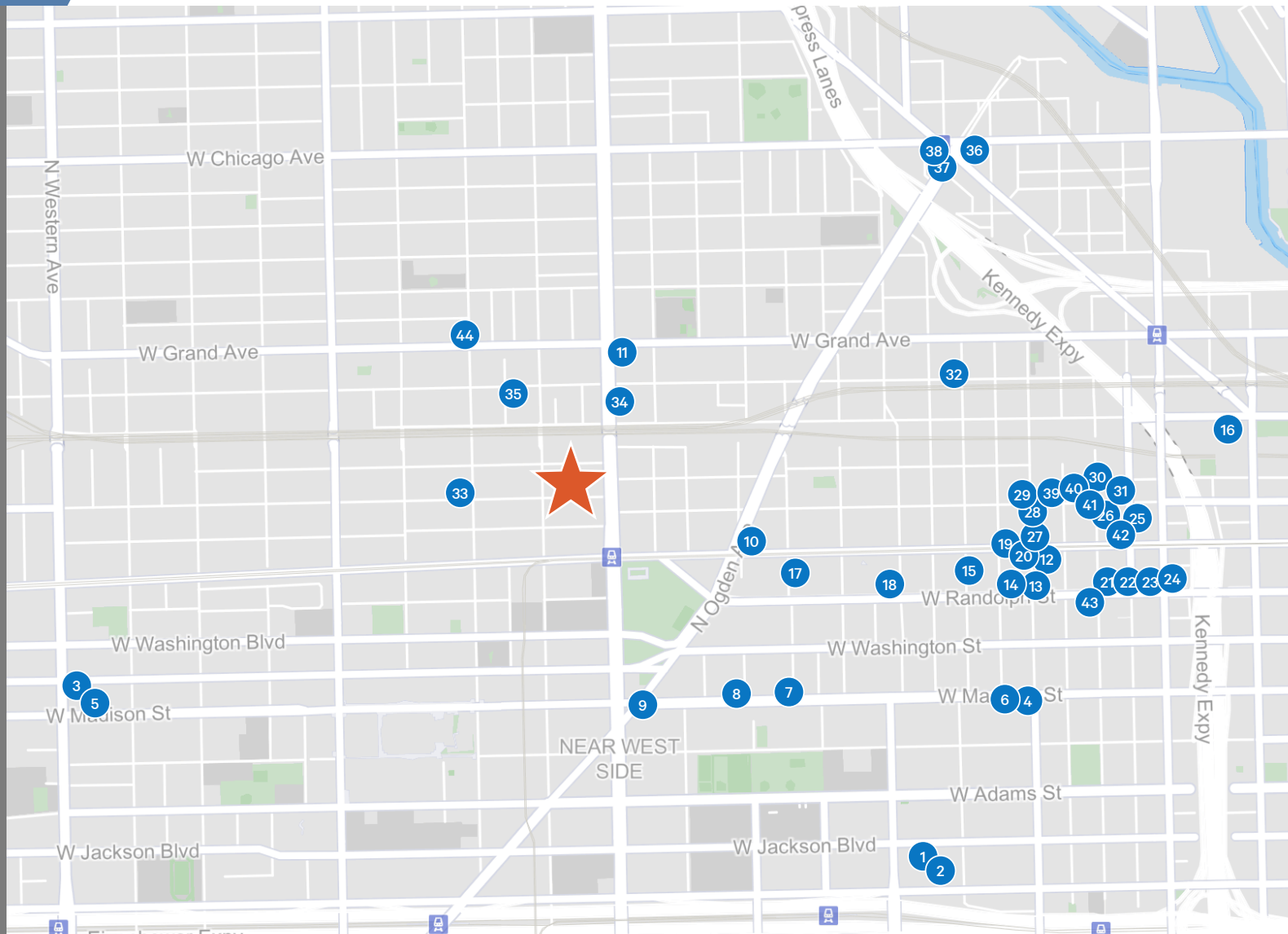

1640 W FULTON STREET, CHICAGO

Matt Cowie
 First Vice President
 +1 312 334 7203
 matt.cowie@cbre.com

John Marks
 Senior Associate
 +1 312 334 7204
 john.marks@cbre.com

Larry Goldwasser, SIOR
 Executive Vice President
 +1 312 334 7201
 larry.goldwasser@cbre.com





1640 W FULTON STREET, CHICAGO

FOR MORE INFORMATION PLEASE CONTACT:

Matt Cowie

First Vice President
+1 312 334 7203
matt.cowie@cbre.com

John Marks

Senior Associate
+1 312 334 7204
john.marks@cbre.com

Larry Goldwasser, SIOR

Executive Vice President
+1 312 334 7201
larry.goldwasser@cbre.com

©2022 CBRE, Inc. All rights reserved. This information has been obtained from sources believed reliable, but has not been verified for accuracy or completeness. You should conduct a careful, independent investigation of the property and verify all information. Any reliance on this information is solely at your own risk. CBRE and the CBRE logo are service marks of CBRE, Inc. All other marks displayed on this document are the property of their respective owners, and the use of such logos does not imply any affiliation with or endorsement of CBRE. Photos herein are the property of their respective owners. Use of these images without the express written consent of the owner is prohibited. PMStudio_April2022

CBRE